

WHITEMAN PROPERTY



4A Brogden Road THE ENTRANCE NORTH NSW

2 2 2

Perfectly set on a deep 462sqm block on the edge of paradise, just a stone's throw to Lake and Beach. This incredible semi-cottage offers a rare opportunity to create the ultimate relaxed lifestyle. Immaculately updated throughout, retaining period features that blend with contemporary updates and serene outdoor entertaining. Just a short walk to beach, parks, or over the bridge into The Entrance town centre for cafes, restaurants and entertainment.

- Light and bright living areas flow to covered alfresco entertaining
- Character features, high ceilings, picture rails, expansive glazing to capture lake views
- Immaculate kitchen with stone benchtops, quality

[For full version visit the website](https://www.whitemanproperty.com.au)

Type : House
Land Size : 462 sqm
View : <https://www.whitemanproperty.com.au/sale/nsw/central-coast-region/the-entrance-north/residential/house/7087481>



Brian Whiteman
02 4384 1349

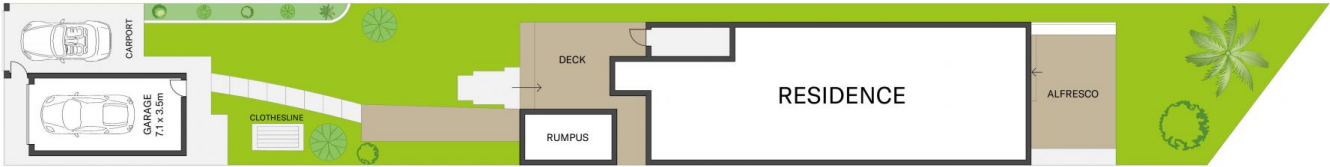

SITE PLAN

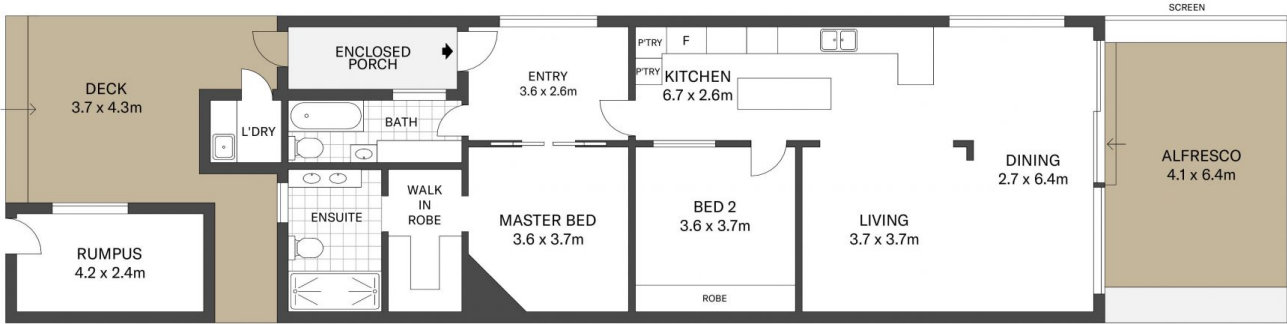

APPROX. INT: 121m²
LAND: 462m²



THE INFORMATION CONTAINED IN THIS DOCUMENT HAS BEEN PROVIDED BY THIRD PARTIES. THE AGENCY HAS NOT CHECKED THE INFORMATION AND MERELY PASSES IT ON, NOT HAVING A BELIEF ONE WAY OR THE OTHER AS TO ITS ACCURACY. INTERESTED PARTIES SHOULD MAKE AND RELY UPON THEIR OWN ENQUIRIES.

 4A Brogden Road, The Entrance North

THE AGENCY