

WHITEMAN PROPERTY



25 Gordon Road LONG JETTY NSW

3  2  2 

Situated 50 metres to the serene foreshores of Long Jetty, this stunning home has been designed to take full advantage of its elevated position overlooking Tuggerah lake. The spacious light-filled interiors are enhanced by the spectacular use of glazing capturing panoramic views from the open plan living and vast wrap around veranda. Ideal for those seeking a lifestyle of serene beauty minutes to lake, beaches and shopping centres.

- Great street appeal, elevated for privacy with dual street access
- Vast open plan living areas with high raked ceilings, easy flow to terrace
- Immaculate kitchen with stone bench; breakfast bar; gas cook top

[For full version visit the website](https://www.whitemanproperty.com.au)

Type : House
Land Size : 455 sqm
View : <https://www.whitemanproperty.com.au/sale/nsw/central-coast-region/long-jetty/residential/house/7084143>



Brian Whiteman
02 4384 1349

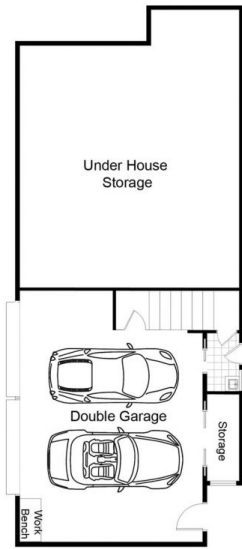

GROUND FLOOR PLAN

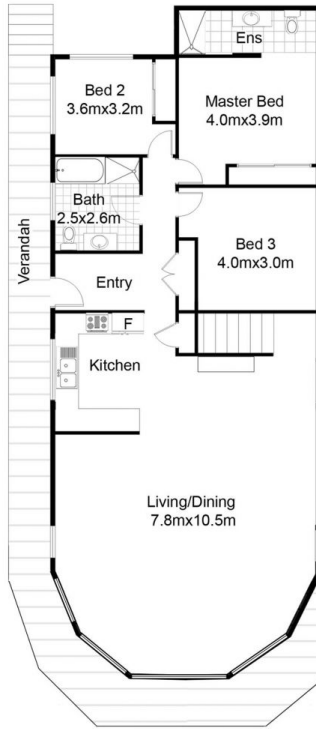

FIRST FLOOR PLAN

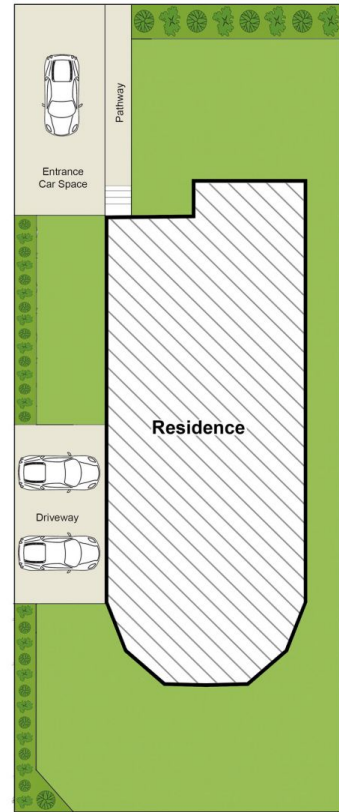

SITE PLAN



LAND SIZE 455 m²

Indicative only. All dimensions and element positions are approximate. Information on this plan comes from sources we believe to be accurate, but its accuracy is not guaranteed. Interested parties should make and rely on their own inquiries

 25 Gordon Road, Long Jetty

THE  AGENCY