

WHITEMAN PROPERTY



65 Fraser Road LONG JETTY NSW

2  1  2 

Original brick and tile home situated on a massive 866sqm block of prime land in one of the Central Coast's most coveted up and coming suburbs. Ripe for renovation, extension or build your dream home/investment on a near level block.

- Original main residence featuring two bedrooms plus sunroom
- Large functional kitchen; adjacent living/dining
- Large 5.3 x 5.2 garage
- Land measurements 17.25 x 55.00m (approx)
- Zoned R1 general residential
- Walk to shops and cafes, surrounded by the best beaches on the Coast

Type : House
Land Size : 866 sqm
View : <https://www.whitemanproperty.com.au/sale/nsw/central-coast-region/long-jetty/residential/house/7084115>



Brian Whiteman
02 4384 1349

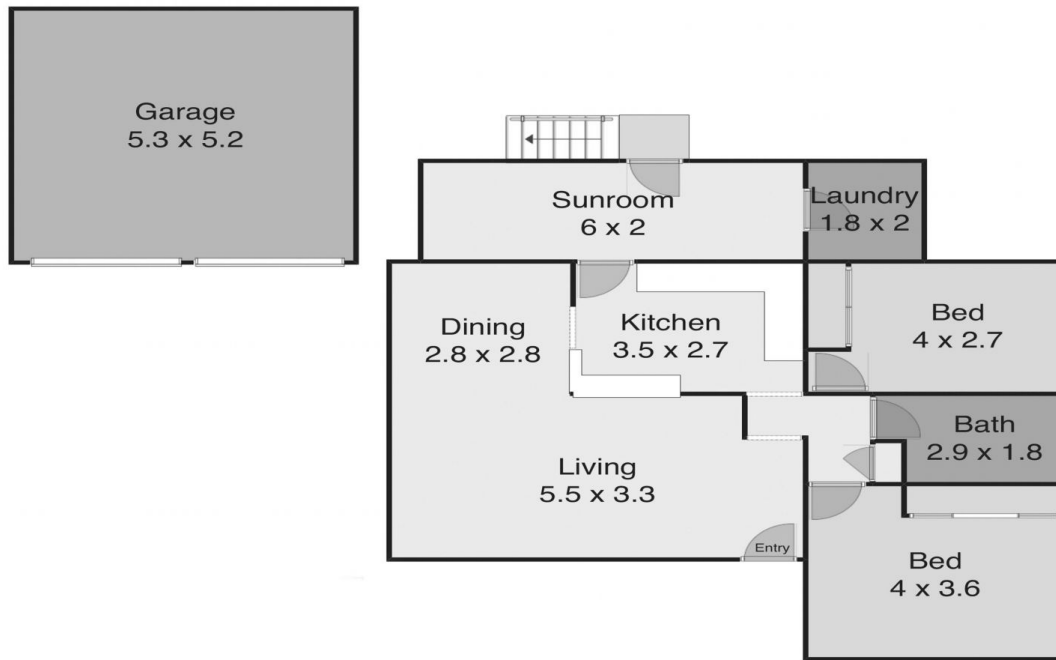

Indicative only. All dimensions and element positions are approximate. Information on this plan comes from sources we believe to be accurate, but its accuracy is not guaranteed. Interested parties should make and rely on their own inquiries

 65 Fraser Road, Long jetty

THE  AGENCY